

Removing a Proxy in CSU Learn

1. Once you log into CSU Learn, click on the “SELF” icon in the top left corner:

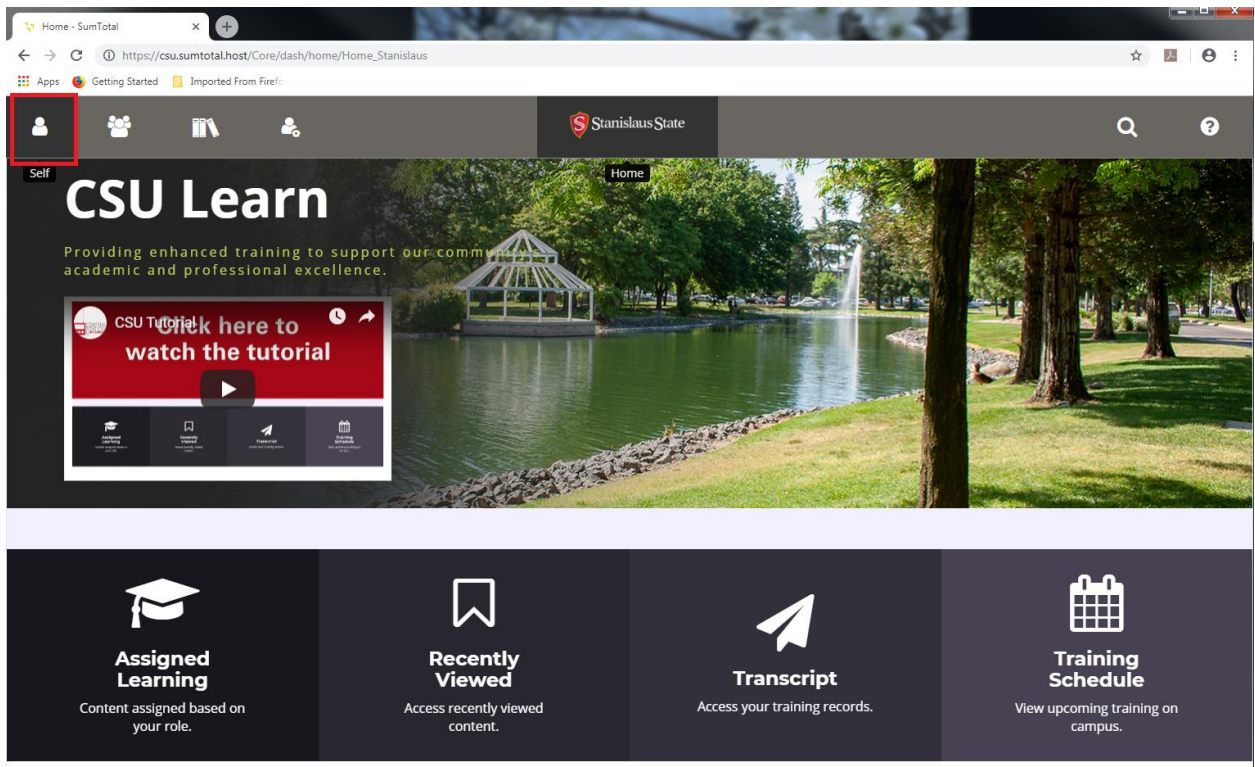

2. On the SELF menu, select “PROXY RELATIONSHIPS.”

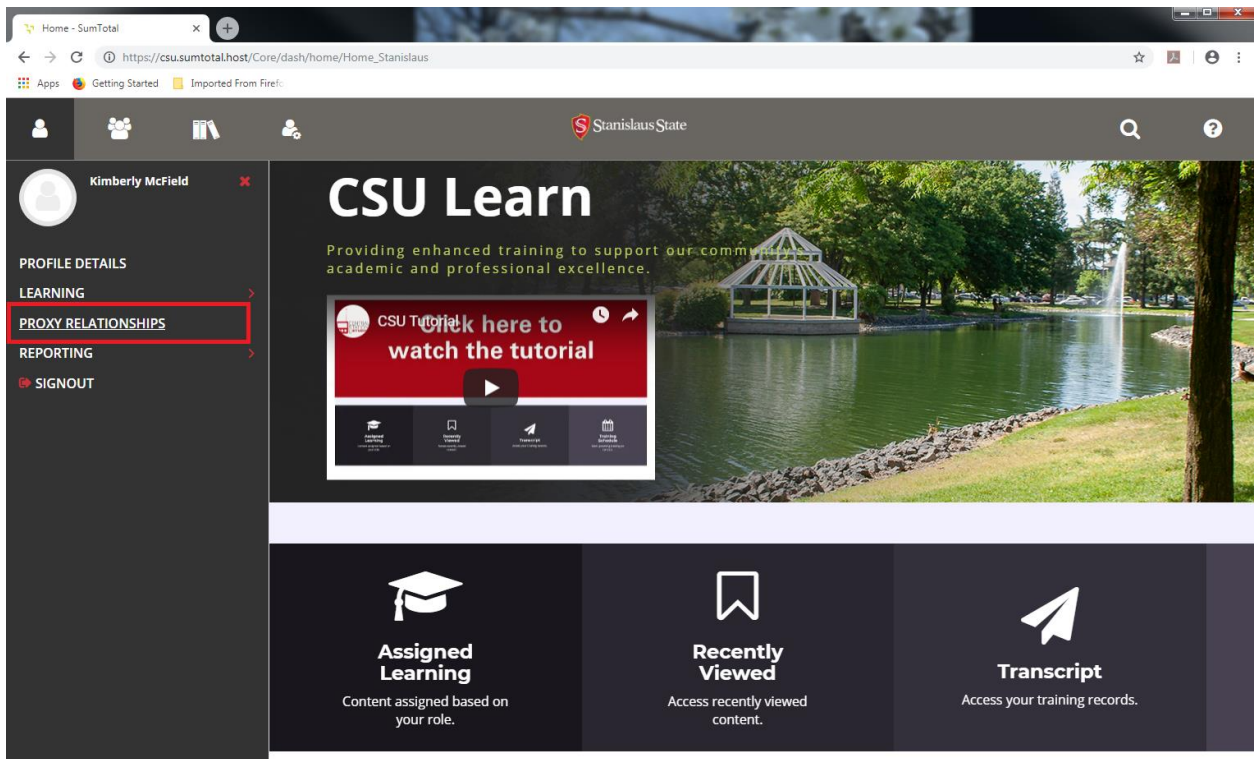

3. On the Proxy Relationships menu, select the proxy you'd like to remove and click the "REMOVE" button.

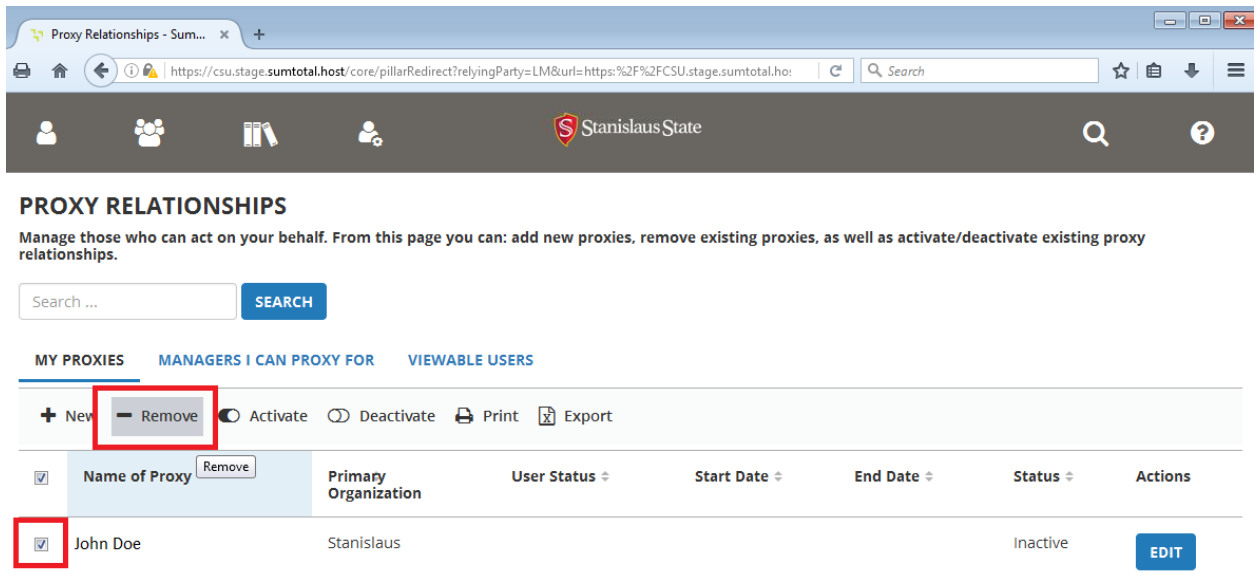

4. On the pop-up window, click "CONTINUE."

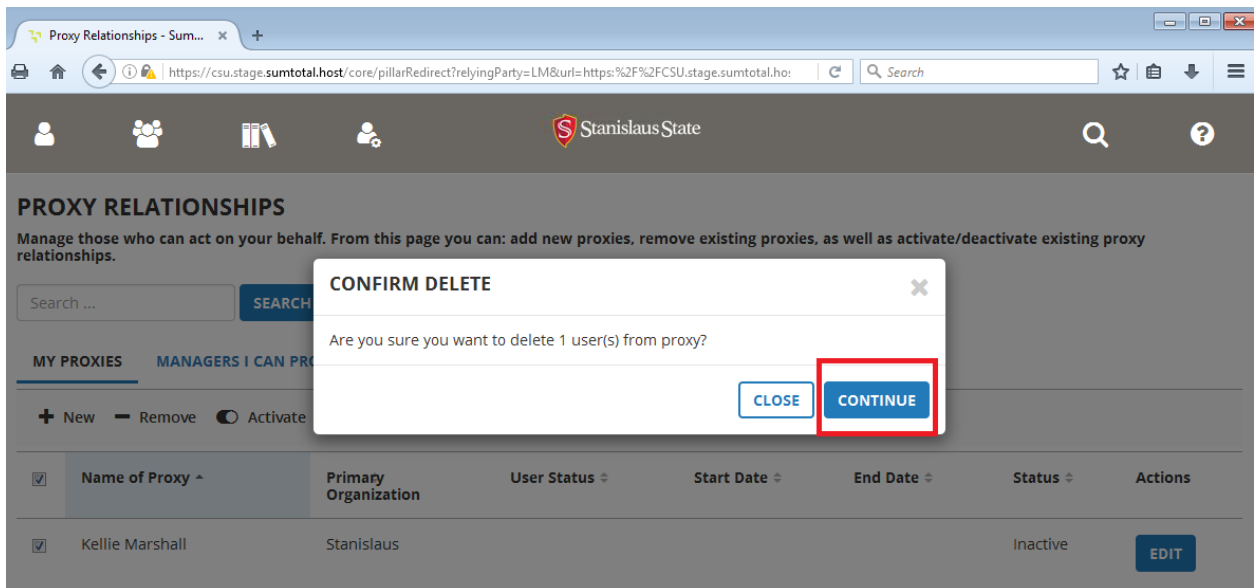

5. The Proxy Relationships page will confirm that you removed your proxy, and that user will no longer appear in your list of proxies.

PROXY RELATIONSHIPS
Manage those who can act on your behalf. From this page you can: add new proxies, remove existing proxies, as well as activate/deactivate existing proxy relationships.

You have successfully deleted 1 proxies.

Search ... **SEARCH**

MY PROXIES **MANAGERS I CAN PROXY FOR** **VIEWABLE USERS**

+ New - Remove Activate Deactivate Print Export

	Name of Proxy ^	Primary Organization ⇅	User Status ⇅	Start Date ⇅	End Date ⇅	Status ⇅	Actions
No Results Found							